

Smarteye offers reliable identification under all conditions of motion, even in the most hostile industrial environments (i.e. paint booths, caustics, chemicals, ovens, steel mills). The Smarteye Sender/Receiver Reader is rugged and built for long-term, low maintenance operation. The unit consists of a Sender/Receiver pair utilizing modulated infrared light to detect the pattern of a passing Smarteye Label. Flexible mounting and simple wiring allow the reader to be mounted to suit most any application.



## Product Features

### Packaging

- ◆ Stainless Steel construction
- ◆ Epoxy-encapsulated, gasketed sensors (UL/CSA/CE approved)
- ◆ Meets NEMA 1, 2, 3, 3S, 4, 4x, 12 and 13 ratings; IEC IP67
- ◆ Operating temperature: -20° to 70°C
- ◆ Explosion-proof enclosure option

### Mounting

- ◆ Units are designed to mount directly to Unistrut or similar structure
- ◆ Flexible bracket design allows multiple mounting orientations
- ◆ Indicator LEDs permit simple alignment
- ◆ Optional pre-engineered mounting assemblies available

### Wiring

- ◆ Reader wiring to junction box: receiver – 6' (1.82m), sender – 25' (7.62m)
- ◆ Each reader may be located up to 1500' (457.2m) from its control unit using Belden 9773 cable or equivalent
- ◆ Power supplied by Smarteye control unit

### Read Distance

- ◆ Up to 84" (2.13m) from sender to receiver depending on application
- ◆ Optional longer read distances are available for special applications

### Models Available

- ◆ SP1052/01
- ◆ SP1054/01
- ◆ SP1055/01

# Mounting Dimensions

# Sender/Receiver/Reader-2

RECEIVER

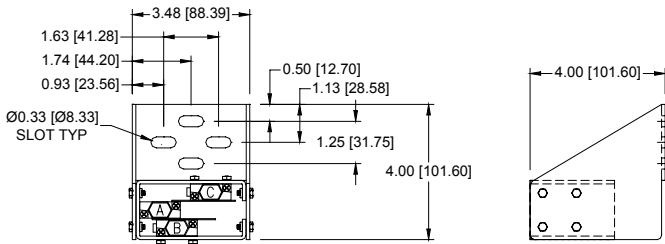

RECEIVER

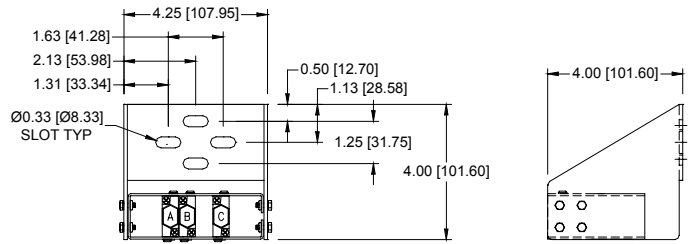

SENDER



SP1052/01

SENDER

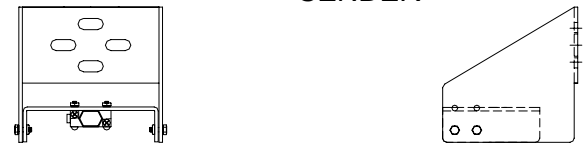

SP1054/01 AND SP1055/01

# Electrical Interconnections

READER PORT

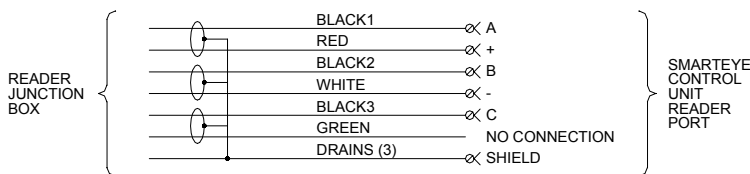

PHOTOEYES JUNCTION BOX SMARTEYE CONTROL UNIT

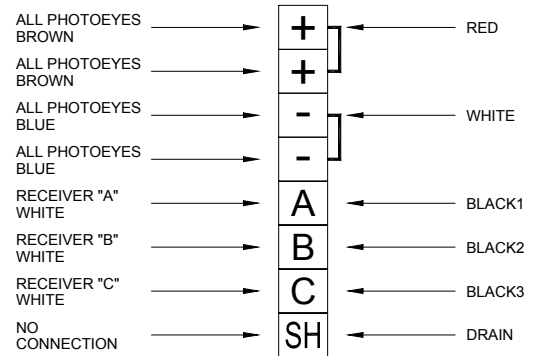

READER-JUNCTION BOX INTERCONNECTION

